

Generic Appliance - Manuals



Rockingham
Forest Park

Breath, Explore, Relax

Heating Instructions

Neo V2 Series Quick Guide



Heating On / Temperature Control

To make a temporary change to the temperature setting press the \vee or \wedge key, set your desired temperature, press \checkmark



If the set temperature is above the room temperature the  symbol will be displayed, indicating the heating is now on.

This set temperature will be maintained until the next comfort level.

Heating Off / Frost Protection

To enable frost protection, use the $<$ $>$ keys to select  then press the \checkmark key once. The  symbol will be displayed.

In this mode the heating will be turned off, but if the temperature falls below your frost protection temperature, the heating will then turn on.

To return to your heating schedule, disable frost protection by using the $<$ $>$ keys to select  then press \checkmark , the  symbol will disappear.

 Heating on  Frost Protection On

Setting The Clock

Use the $<$ $>$ keys to select  then press and hold the \checkmark key.

Use the $>$ key to select CLOCK, press the \checkmark key.

Use the \vee \wedge keys to set the year, press \checkmark

Repeat the steps to set the month, day, hours & minutes.

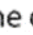
Use the \vee key to select , press the \checkmark key to turn the display on.

Note: The clock will automatically set when paired to the neoHub.

Editing Comfort Levels

Use the $<$ $>$ keys to select EDIT, press the \checkmark key once.

Use the $<$ $>$ keys to select the days to edit, press \checkmark

WAKE will now flash, press the \checkmark key to edit the WAKE level.

Use the \vee \wedge keys to adjust the hours, press \checkmark

Use the \vee \wedge keys to adjust the minutes, press \checkmark

Use the \vee \wedge keys to adjust the temperature, press \checkmark

Use the $<$ $>$ keys to select LEAVE, press \checkmark

Repeat the steps above for the Leave, Return & Sleep settings.

For any levels that you don't want to use, adjust the time to --:--

To confirm changes and exit, use $<$ $>$ to select DONE, press \checkmark

K'A'RCHER Vacuum cleaner

Operation:

Connect the mains plug.

Regulate the suction power on the suction control (variable).

Set the floor nozzle switch to hard floor or carpet (press with foot).

Switch off device at the main switch.

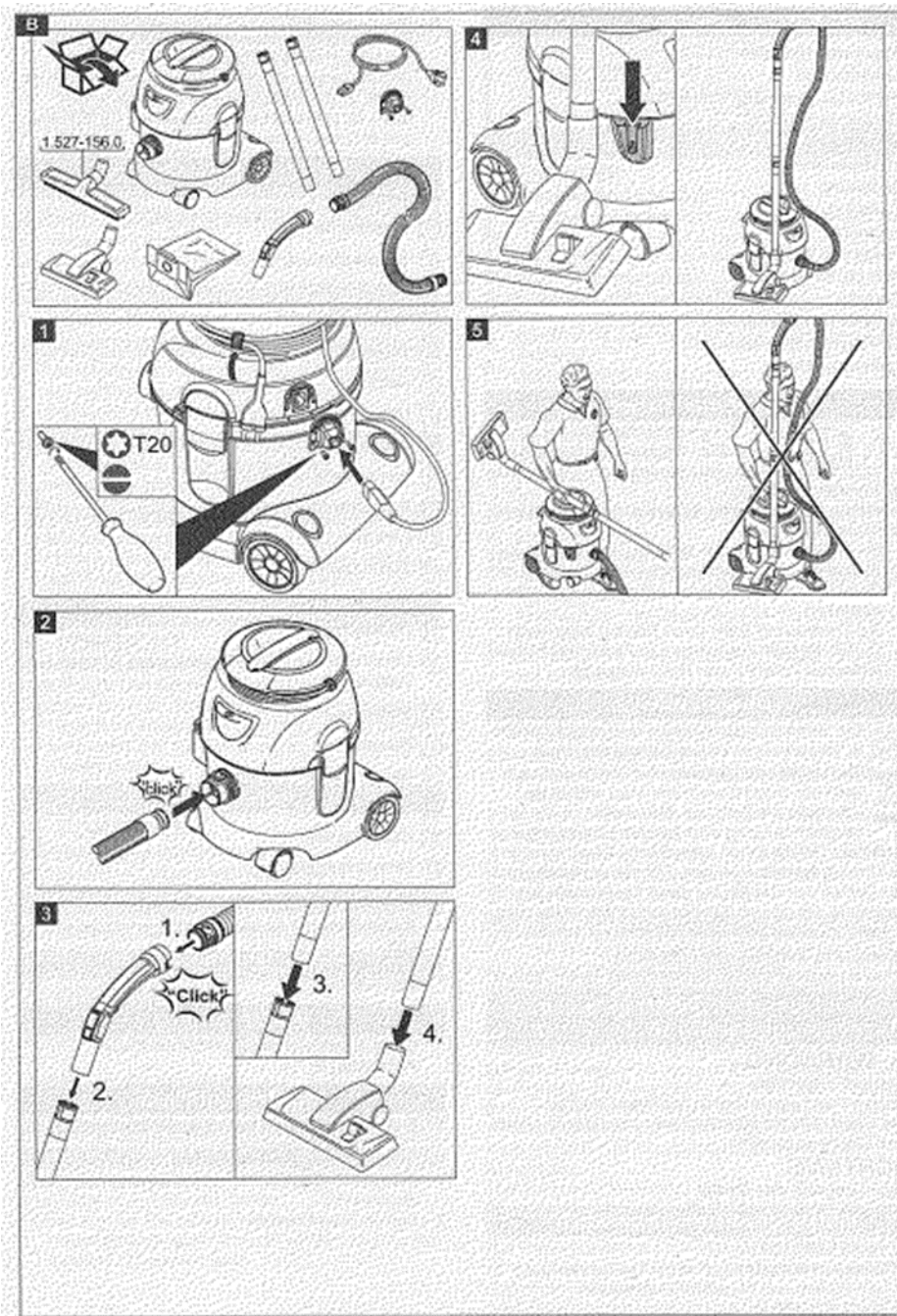

Safe Instructions

Setting the user code;

With the door open, press the reset button one, start setting code when the yellow lights go on.

Input new code (3-8 digits) and press the "A" (C / #) or "B" (E / *) button to confirm with 2 buzzer beeps, which indicates the acceptance and storage of the new code.

If the yellow light flashes with 3 buzzer beeps, which means the code changing is not effective, and you need to try again.



Laundry service

A laundry service is available during your stay.

This service is outsourced by our onsite cleaning company, OLC Cleaning.

The **text** line 07859 547983 is open from Monday to Friday 9-4 for booking. Out of these hours there will be no collection or delivery and any booking queries will be answered on the next working day. Any booking made on a Friday; items will be returned on a Monday morning.

Collection of laundry will be at 9:30am or 3:30pm and will be returned the following day. Items must be placed in a bag or basket for collection please.

We are unable to enter lodges and require you to be home to receive your laundry. We are unable to leave items outside of lodges.

Payment via **CARD ONLY** on delivery please.

Wash and Fold:

7kg £15

12kg £20

15kg £25

Ironing service ONLY:

Shirt on Hanger

£2.50

T-Shirt on Hanger

£2.00

T shirt Folded £1.75.

Top/Blouse

£2.50

Trousers

£3.00

Shorts

£2.50

Skirt

£3.00

Children's clothes

£1 per item.